

CITY OF DE PERE

Building Inspection

335 South Broadway, De Pere, WI 54115 | 920-339-4053 | www.deperewi.gov



FENCES & HEDGES

1. Definition.

For the purposes of this ordinance, a fence is herein defined as an enclosing barrier constituting of vegetation, wood, stone, metal, or other material. The term “fence” shall be construed to include plantings, such as hedges. Please follow the link to our Municipal Code [DPMC 54-7](#).

2. Lot Lines and Boundaries.

The City of De Pere does not locate the property survey pins, this is the responsibility of the homeowner.

- a. Property line disputes are not the City’s responsibility, which would result in a possible civil matter.
- b. Contact a licensed surveyor for professional services in locating your property lines and/or an attorney for legal advice regarding your rights as a property owner. The City Building Inspection Division will not and cannot offer any legal advice regarding property line disputes or any other civil matter.
- c. Contact **Diggers Hotline (811 or (800) 242-8511)** to find all underground utilities to the property to avoid any potential problems and dangers during post placement. You can also file online at [Diggers Hotline](#).
- d. Easements: fences, walls or shrubbery installed or constructed in a drainage easement cannot impede normal water drainage and if installed or constructed in a utility easement may be removed by the utility company for service work at the owner’s cost.

3. General Regulations.

No fence shall have sharp or pointed pickets dangerous to life or limb. The following fence types are prohibited: barbed wire fences; permanent chicken wire; wire or plastic mesh-type fencing with a wire mesh diameter thinner than 11-gauge wire; hardware cloth; snow fencing; and agricultural fencing including but not limited to deer fencing, electrical fences, and single, double and triple strand fences. Hedges and other plantings shall be continuously trimmed and all parts thereof confined to the property on which planted.

4. Residential Fences.

- a. No fence exceeding (3) three feet in height shall be allowed within the front yard

or corner side yard building setback limits.

- a. Fences may be constructed to a height of (4) four feet in corner side yards and front yards of lots rather than corner or through lots provided the same is a see-through design (60% plus visibility: chain-link or small diameter picket style).
- b. The maximum height of fences on any other boundary line shall not be more than (6) six feet.

5. Fence Construction and Design Regulations.

- a. The attractive side of the fence shall face the adjoining property, meaning the posts shall be located on the property side and the panels facing the adjoining property.
- b. The height of the fence shall be determined from the finished grade to the top of the highest portion of the fence panel. Where the fence is separated by a grade difference with a neighboring property, such as a retaining wall or berm, the fence height shall be determined based on the average of the highest and lowest grade.
- c. The building code does not establish minimum depth requirements for installing fence posts. A general rule of thumb is to place the posts into the ground a minimum of half the height of the fence. Please note that the minimum frost depth for this area is 48”.
- d. Fences are allowed to be placed up to the property lines but in no case can the fencing extend over the property line. It is recommended that the fence be constructed off the lot line if maintenance will need to be done to the fencing without going onto the neighboring property.

6. Hedges and Other Plantings.

Hedges and other plantings may be permitted to grow to their natural height provided that such growth within the setback limits of street right-of-way does not create a traffic or safety hazard. The Chief of Police shall be primarily responsible for determining the safety and traffic factors of such growth and shall report any hazardous situations to the Building Inspector who shall notify the property owner and direct that such hedge be trimmed to a height consistent with safe use of a public right-of-way, or removed if necessary.

7. Commercial, Industrial Fences.

Fences used for industrial or commercial purposes shall have a maximum height of (8) eight feet. Arms or extensions which project from the fence must project into the lot proper. No fence or other structure consisting in whole or in part of barbed wire, rods, or bands or other material dangerous to life and limb, shall be erected along or within four feet of any public streets, sidewalks, or alleys in the City.

8. Enforcement and Penalties.

Any person who violates the foregoing provisions shall be subject to a forfeiture of not

less than \$5.00 and not more than \$200.00 for each offense. Upon notification of violation by the Building Inspector, each day a violation is allowed to continue to exist shall constitute a separate violation.

Prior to obtaining a permit application for a fence, please check with your subdivision covenant to see if there are any restrictions you will need to adhere to.

Illustrations

Fences, Walls & Hedges Height Limits

Vision Corner Triangle

Yards
F – Front Yard
S – Side Yard
CS – Corner Side Yard
R – Rear Yard

Areas S & R
 Maximum 6 ft tall fencing, walls & hedges allowed in the Rear and Side Yards.

Areas F & CS
 Maximum 3 ft tall fencing, walls & hedges allowed in the Front and Corner Side yards,

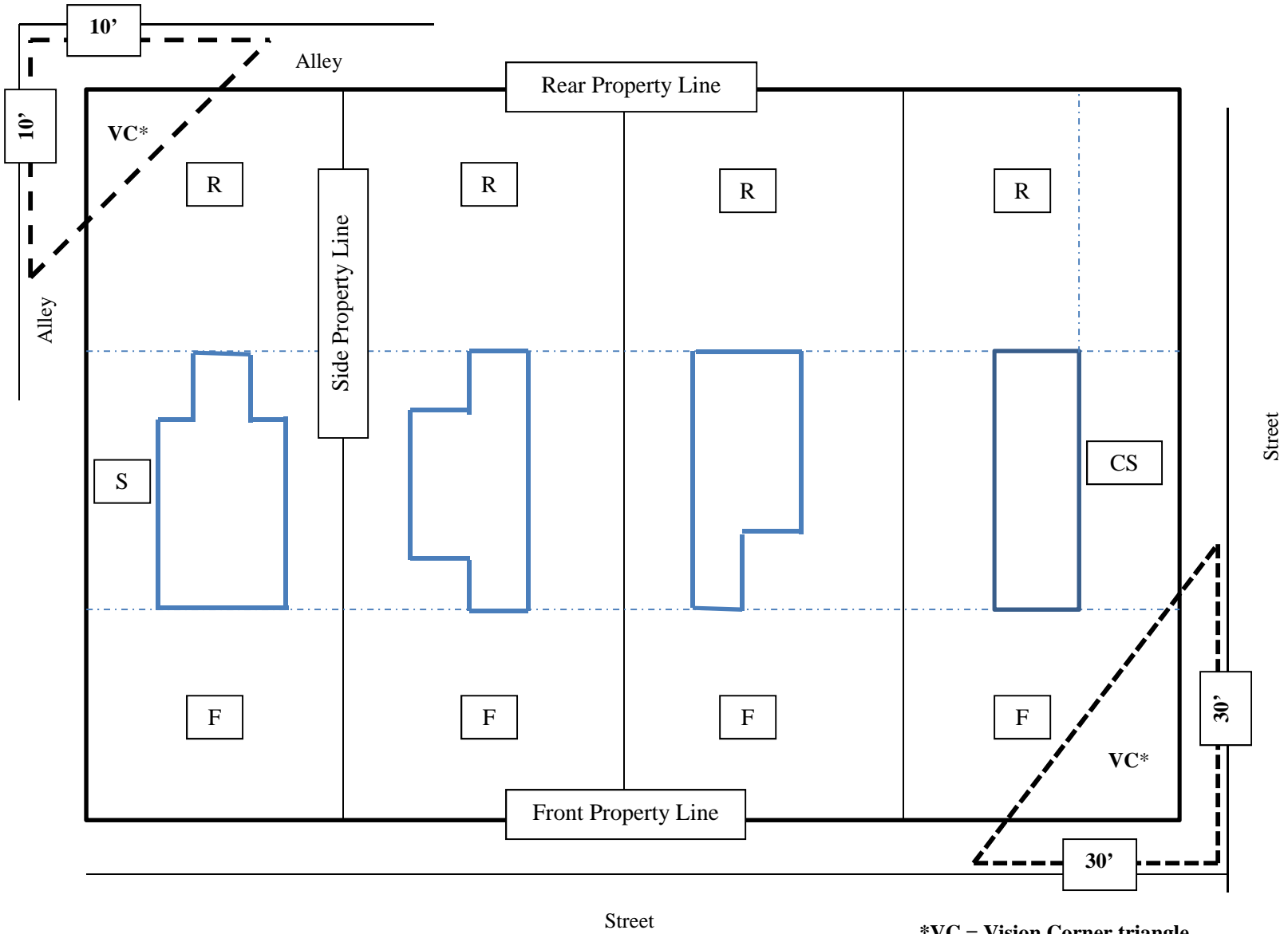

*VC = Vision Corner triangle